



#### DESCRIZIONE TECNICA / TECHNICAL DESCRIPTION

**TOP** Legno con bordo sagomato rivestito in pelle Vermont. Superficie piana impiallacciata Warm Grey Fiddleback Sycamore oppure radica Burr Walnut, finitura lucida spazzolata

Dettagli in acciaio finitura canna di fucile

**SPECIAL CUSTOMIZATION:** speciale laccatura Glaze Earth, Glaze Slate o Glaze Greige, finitura lucida spazzolata oppure radica Chestnut, finitura lucida spazzolata (prezzi su richiesta)

**GAMBE** Legno impiallacciato coordinato all'essenza top, oppure rivestito in pelle Vermont coordinata al bordo top. Piedini in acciaio finitura canna di fucile

**OPTIONAL DIAMOND** Solo per BTV (15EE) e BTV (16EE) con top in radica Burr Walnut, gambe in legno impiallacciato radica Burr Walnut intarsiato a rombi con filetti di acero bianco. Piedini in acciaio finitura canna di fucile

**TOP** Wooden edge covered in Vermont leather. Top veneered Warm Grey Fiddleback Sycamore, Burr Walnut briar-root, with glossy brushed finishing  
Steel details with gun-metal grey finishing

**SPECIAL CUSTOMIZATION:** special lacquering Glaze Earth, Glaze Slate or Glaze Greige, with glossy brushed finishing or Chestnut briar-root, with glossy brushed finishing (prices upon request)

**LEGS** Wood veneered with wooden top, or covered in leather Vermont coordinated with top edge. Small steel feet with gun-metal grey finishing

**OPTIONAL DIAMOND** Only for BTV (15EE) and BTV (16EE) with Burr Walnut briar-root top: wooden legs veneered Burr Walnut briar-root with white maple rhombus. Small steel feet with gun-metal grey finishing



**BENTLEY HOME**  
**tables & writing-desks**  
**SHERWOOD**

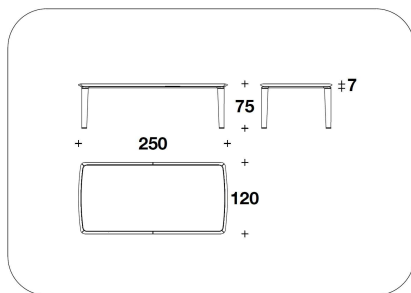

BTV (15EE) - BTV (15EP)  
TAVOLO / TABLE  
250x120x75H. - THK.7cm  
98 1/3x47 1/3x29 2/3H. - THK.2 3/4"

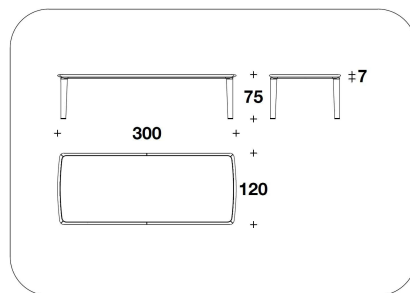

BTV (16EE) - BTV (16EP)  
TAVOLO / TABLE  
300x120x75H. - THK.7cm  
118x47 1/3x29 2/3H. - THK.2 3/4"

**Note**